

# Saddle Tap

## Detail

- Press-On Saddle Tap
- Galvanized Steel (ASTM A653 and A924)
- G-60 Galvanized Coating (ASTM A653 and ASTM 90)
- Available in Specialty Metals:
  - Aluminum (ASTM B209 Alloy 3003 Temper H14)
  - 304 Stainless Steel (ASTM A480 2B Finish)
- Pressure Rating: Designed per SMACNA Third Edition 2005 Section 4.8 Figure 4-6 Brand Connections
- Dimensional Tolerance:  $\pm 1/4"$
- Sealed joints
- Non-damper taps are supplied with 3/8" knock-outs



## Profile

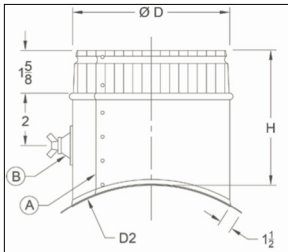

| Saddle Tap | Option                    | Collar Diameter | Pipe Diameter | Material                            | Gauge             | Option                                 | Option                 |
|------------|---------------------------|-----------------|---------------|-------------------------------------|-------------------|--|------------------------|
| ST         | S2<br>2" Stand off option | 6               | 10            | GA - Galv.<br>S4 - SS304<br>AL - AL | 26,24<br>26<br>32 | DS= Damper<br>DCS= 3/8" Rod and Damper | 38<br>= Rossi Hardware |

Item Code Example: ST610GA26 = Saddle Tap 6" Collar on 10" Round, Galv., 26 ga.

## Packaging

| Collar Dia (D) | Pipe Dia (D2)  | H      | Carton Qty | Collar Dia (D) | Pipe Dia (D2)                        | H      | Carton Qty |
|----------------|--|--------|------------|----------------|--------------------------------------|--------|------------|
| 4"             | 6"<br>8"-10"   | 5 3/4" | 30         | 12"            | 12"<br>14"-16"<br>18"-20"<br>22"-24" | 7 3/4" | 10         |
| 5"             | 7"-9"<br>10"-12"                                       | 5 3/4" | 25         | 14"            | 14"<br>16"-18"<br>20"-22"<br>24"-26" | 7 3/4" | 5          |
| 6"             | 6"<br>7"-8"<br>8"-10"<br>12"-14"<br>16"-18"<br>20"-22" | 5 3/4" | 20         | 16"            | 16"<br>18"-20"<br>22"-24"            | 7 3/4" | 5          |
| 7"             | 10"-12"<br>14"-16"                                     | 5 3/4" | 20         | 18"            | 18"<br>20"-22"<br>24"                | 7 3/4" | 5          |
| 8"             | 8"<br>10"-12"<br>14"-16"<br>18"-20"<br>22"-24"         | 5 3/4" | 20         | 20"            | 20"<br>22"-24"                       | 7 3/4" | 5          |
| 10"            | 10"<br>12"-14"<br>16"-18"<br>20"-22"                   | 5 3/4" | 10         |                |                                      |        |            |

Available in 26 and 24 Gauge (4" on 6" in 26 ga only)

## CONTACT

Office: 888.973.7600

1100 Ashwood Drive  
Suite 1102  
Canonsburg, PA 15317

[www.clward.com](http://www.clward.com)